



Air Conditioning Technical Data

Floor standing unit



EEDEN15-204

FXLQ-P

TABLE OF CONTENTS

FXLQ-P

1	Features	2
2	Specifications	3
	Technical Specifications	3
	Electrical Specifications	3
3	Safety device settings	5
4	Options	6
5	Capacity tables	7
	Cooling Capacity Tables	7
	Heating Capacity Tables	8
6	Dimensional drawings	9
7	Centre of gravity	11
8	Piping diagrams	12
9	Wiring diagrams	13
	Wiring Diagrams - Single Phase	13
10	Sound data	14
	Sound Pressure Spectrum	14

1 Features

For perimeter zone air conditioning

- Unit can be installed as free standing model by use of optional back plate
- Its low height enables the unit to fit perfectly beneath a window
- Stylish modern casing finished in pure white (RAL9010) and iron grey (RAL7011) blends easily with any interior
- Requires very little installation space
- Wall mounted installation facilitates cleaning beneath the unit where dust tends to accumulate
- Wired remote control can easily be integrated in the unit



Inverter



Home leave operation



Fan only



Auto cooling-heating changeover



Fan speed steps



Dry programme



Air filter



Weekly timer



Infrared remote control



Wired remote control



Centralised control



Auto-restart



Self diagnosis



Multi tenant

2 Specifications

2-1 Technical Specifications				FXLQ20P	FXLQ25P	FXLQ32P	FXLQ40P	FXLQ50P	FXLQ63P	
Cooling capacity	Nom.		kW	2.2 (1)	2.8 (1)	3.6 (1)	4.5 (1)	5.6 (1)	7.1 (1)	
Heating capacity	Nom.		kW	2.5 (2)	3.2 (2)	4.0 (2)	5.0 (2)	6.3 (2)	8.000 (2)	
Power input - 50Hz	Cooling	Nom.	kW	0.049 (1)		0.090 (1)		0.110 (1)		
	Heating	Nom.	kW	0.049 (2)		0.090 (2)		0.110 (2)		
Power input - 60Hz	Cooling	Nom.	kW	0.047 (1)		0.079 (1)	0.084 (1)	0.105 (1)	0.108 (1)	
	Heating	Nom.	kW	0.047 (2)		0.079 (2)	0.084 (2)	0.105 (2)	0.108 (2)	
Dimensions	Unit	Height	mm	600						
		Width	mm	1,000	1,140		1,420			
		Depth	mm	232						
	Packed unit	Height	mm	720						
		Width	mm	1,128	1,268		1,548			
		Depth	mm	346						
Weight	Unit		kg	27		32		38		
	Packed unit		kg	32		37		43		
Casing	Colour		Fresh white (RAL9010) / Dark grey (RAL7011)							
Heat exchanger	Rows	Quantity		3						
	Fin pitch		mm	1.5						
	Face area		m ²	0.159	0.200		0.282			
	Stages	Quantity		14						
	Fin	Type		Cross fin coil						
Fan	Type		Sirocco fan							
	Air flow rate - 50Hz	Cooling	High	m ³ /min	7	8	11	14	16	
			Low	m ³ /min	6		8.5	11	12	
	Air flow rate - 60Hz	Cooling	High	m ³ /min	7	8	11	14	16	
			Low	m ³ /min	6		8.5	11	12	
Fan motor	Output	High	W	15	25		35			
	Drive		Direct drive							
Air filter	Type		Resin net							
Sound pressure level	Cooling	High	dBA	35		38	39	40		
		Low	dBA	32		33	34	35		
	Heating	High	dBA	35		38	39	40		
		Low	dBA	32		33	34	35		
Refrigerant	Type		R-410A							
	Control		Electronic expansion valve							
Piping connections	Liquid	Type		Flare connection						
		OD	mm	6.35		9.52				
	Gas	Type		Flare connection						
		OD	mm	12.7		15.9				
	Drain		O.D. 21 (Vinyl chloride)							
	Heat insulation		Glass Fiber/Urethane Foam							
Sound absorbing insulation		Glass fiber / Urethane foam								
Temperature control	Microprocessor thermostat for cooling and heating									
Safety devices	Item	01	Fuse							
		02	Fan motor thermal protection							
Control systems	Infrared remote control		BRC4C65							
	Simplified wired remote control for hotel applications		BRC2E52C (heat recovery type) / BRC3E52C (heat pump type)							
	Wired remote control		BRC1D52 / BRC1E52A/B							
2-2 Electrical Specifications				FXLQ20P	FXLQ25P	FXLQ32P	FXLQ40P	FXLQ50P	FXLQ63P	
Power supply	Name		VE							
	Phase		1~							
	Frequency		Hz	50/60						
	Voltage		V	220-240/220						
Voltage range	Min.			%						
	Max.			%						

2 Specifications

2

2-2 Electrical Specifications			FXLQ20P	FXLQ25P	FXLQ32P	FXLQ40P	FXLQ50P	FXLQ63P
Current - 50Hz	Minimum circuit amps (MCA)	A	0.3		0.6			
	Maximum fuse amps (MFA)	A	15					
	Full load amps (FLA)	Total	A	0.2		0.5		
Current - 60Hz	Minimum circuit amps (MCA)	A	0.3		0.5		0.6	
	Maximum fuse amps (MFA)	A	15					
	Full load amps (FLA)	Total	A	0.2		0.4		0.5

Notes

(1) Cooling: indoor temp. 27°CDB, 19°CWB; outdoor temp. 35°CDB; equivalent piping length: 7.5m (horizontal)

(2) Heating: indoor temp. 20°CDB; outdoor temp. 7°CDB, 6°CWB; equivalent refrigerant piping: 7.5m (horizontal)

Capacities are net, including a deduction for cooling (an addition for heating) for indoor fan motor heat.

Voltage range: units are suitable for use on electrical systems where voltage supplied to unit terminal is not below or above listed range limits.

Maximum allowable voltage range variation between phases is 2%.

MCA/MFA: $MCA = 1.25 \times FLA$

$MFA \leq 4 \times FLA$

Next lower standard fuse rating minimum 15A

Select wire size based on the value of MCA

Instead of a fuse, use a circuit breaker

3 Safety device settings

3 - 1 Safety Device Settings

FXLQ-P		FXLQ20P	FXLQ25P	FXLQ32P	FXLQ40P	FXLQ50P	FXLQ63P
PC BOARD FUSE		250V 5A					
FAN MOTOR THERMAL PROTECTOR	°C	OFF: 135 ^{±10} / ON: 120 or less					
							3D034529G

4 Options

4 - 1 Options

4

FXLQ-P			
Item	Type	FXLQ20,25P2	FXLQ32,40P2
Remote control	Wired type		BRC1D52 / BRC1E51A*2 BRC1E52A7 *3 / BRC1E52B7 *4
	Infrared type	HP	BRC4C65
		CO	
Simplified remote control (with operation mode selector button)			BRC2E52C *5
Simplified remote control (without operation mode selector button)			BRC3E52C *5
Remote control for hotel use			BRC3A61
Adapter for wiring			KRP1B61
Wiring adapter for electrical appendices (1)			KRP2A51
Wiring adapter for electrical appendices (2)			KRP4A51
Remote sensor			KRCS01-1
Central remote control			DCS302B51
Electrical box with earth terminal (3 blocks)			KJB311A
Unified ON/OFF controller			DCS301BA51
Electrical box with earth terminal (2 blocks)			KJB212A
Noise filter (for electromagnetic interface use only)			KEK26-1
Schedule timer			DST301BA51
External adapter for outdoor unit (installation on indoor unit)			DTA104A61
Long life replacement filter		KAFJ361K28	KAFJ361K45
Rear decoration panel		EKRDP25A9	EKRDP40A9
Multi tenant *1			EKMTAC
Digital input adapter			BRP7A51 *6, *7

NOTES

- *1. This kit contains parts to connect with 10 multi tenant indoor units
- *2. Included languages are: English, German, French, Dutch, Spanish, Italian, Greek, Portuguese, Russian and Turkish
- *3. Included languages are: English, German, French, Dutch, Spanish, Italian, Greek, Portuguese, Russian, Turkish and Polish
- *4. Included languages are: English, German, Albanian, Bulgarian, Croatian, Czech, Hungarian, Romanian, Serbian, Slovak and Slovenian
- *5. Included languages are:
 Language pack 1: English, German, French, Dutch, Spanish, Italian and Portuguese.
 With PC cable EKPCAB3 in combination with the updater PC software, you can additionally change the language to:
 Language pack 2: English, Bulgarian, Croatian, Czech, Hungarian, Romanian and Slovenian.
 Language pack 3: English, Greek, Polish, Russian, Serbian, Slovak and Turkish.
- *6. Only possible in combination with simplified remote control BRC/3E52C.
- *7. Requires installation box for adapter PCB.

4D082403A

5 Capacity tables

5 - 1 Cooling Capacity Tables

FXLQ-P

TC: Total capacity; kW
 SHC: Sensible heat capacity; kW

Unit size	Indoor air temp.													
	14.0 °CWB		16.0 °CWB		18.0 °CWB		19.0 °CWB		20.0 °CWB		22.0 °CWB		24.0 °CWB	
	20.0 °CDB		23.0 °CDB		26.0 °CDB		27.0 °CDB		28.0 °CDB		30.0 °CDB		32.0 °CDB	
	TC	SHC	TC	SHC	TC	SHC	TC	SHC	TC	SHC	TC	SHC	TC	SHC
20	1.5	1.3	1.8	1.5	2.1	1.7	2.2	1.7	2.3	1.7	2.4	1.6	2.4	1.5
25	1.9	1.6	2.3	1.8	2.6	2.0	2.8	2.1	3.0	2.1	3.0	2.0	3.1	1.9
32	2.4	2.1	2.9	2.2	3.4	2.5	3.6	2.5	3.8	2.5	3.9	2.4	4.0	2.3
40	3.0	2.5	3.6	2.7	4.2	3.1	4.5	3.1	4.7	3.2	4.9	3.1	5.0	2.9
50	3.8	3.0	4.5	3.4	5.2	3.8	5.6	3.9	5.9	4.0	6.0	3.8	6.2	3.6
63	4.8	3.7	5.7	4.2	6.6	4.8	7.1	4.9	7.5	4.9	7.7	4.7	7.8	4.3

CA03A095

5 Capacity tables

5 - 2 Heating Capacity Tables

5

FXLQ-P

Unit size	Indoor air temp. °CDB					
	16.0 kW	18.0 kW	20.0 kW	21.0 kW	22.0 kW	24.0 kW
20	2.6	2.6	2.5	2.4	2.3	2.2
25	3.4	3.4	3.2	3.1	3.0	2.8
32	4.2	4.2	4.0	3.9	3.7	3.5
40	5.2	5.2	5.0	4.8	4.7	4.4
50	6.6	6.6	6.3	6.1	5.9	5.5
63	8.4	8.4	8.0	7.7	7.5	7.0

CA03A096

6 Dimensional drawings

6 - 1 Dimensional Drawings

FXLQ20-25P

Required installation space

Item	Name	Description
1	Liquid pipe connection	Ø6.4 Flare connection
2	Gas pipe connection	Ø12.7 Flare connection
3	Drain pipe connection	O.D.Ø21
4	Switch box	
5	Air filter	

3TW32294-1

FXLQ32-40P

Required installation space

Item	Name	Description
1	Liquid pipe connection	Ø6.4 Flare connection
2	Gas pipe connection	Ø12.7 Flare connection
3	Drain pipe connection	O.D.Ø21
4	Switch box	
5	Air filter	

3TW32314-1

6 Dimensional drawings

6 - 1 Dimensional Drawings

6

FXLQ50-63P

Required installation space

Model	A	B
FXL050	Ø6.4	Ø12.7
FXL063	Ø9.5	Ø15.9

Item	Name	Description
1	Liquid pipe connection	ØA Flare connection
2	Gas pipe connection	ØB Flare connection
3	Drain pipe connection	O.D.Ø21
4	Switch box	
5	Air filter	

Level adjusting screw in standard accessory
4xM6
2-12x18 Oblong hole
Hole for fixing to the floor
Wiring hole (bottom)
Piping hole (bottom)
Piping hole (rear)
4-12x30 Oblong hole
Hole for rear mounting

3TW32334-1

7 Centre of gravity

7 - 1 Centre of Gravity

FXLQ-P

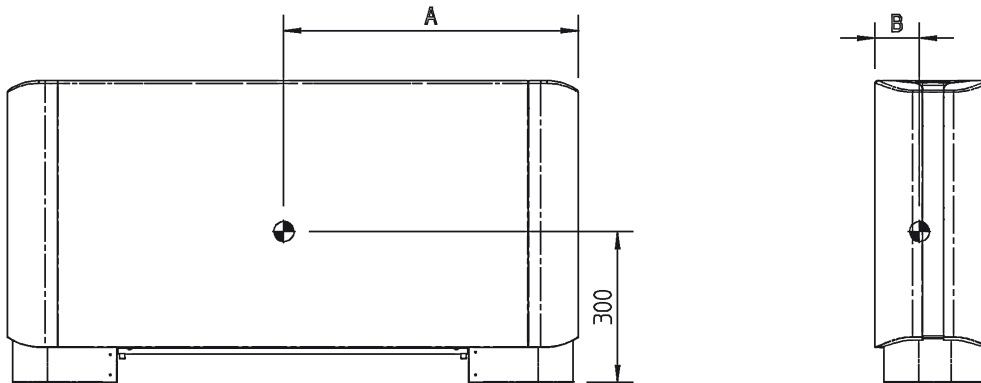

Model	A	B
FXLQ 20, 25 P	500	81
FXLQ 32, 40 P	588	89
FXLQ 50, 63 P	728	99

4TW32299-2

8 Piping diagrams

8 - 1 Piping Diagrams

8

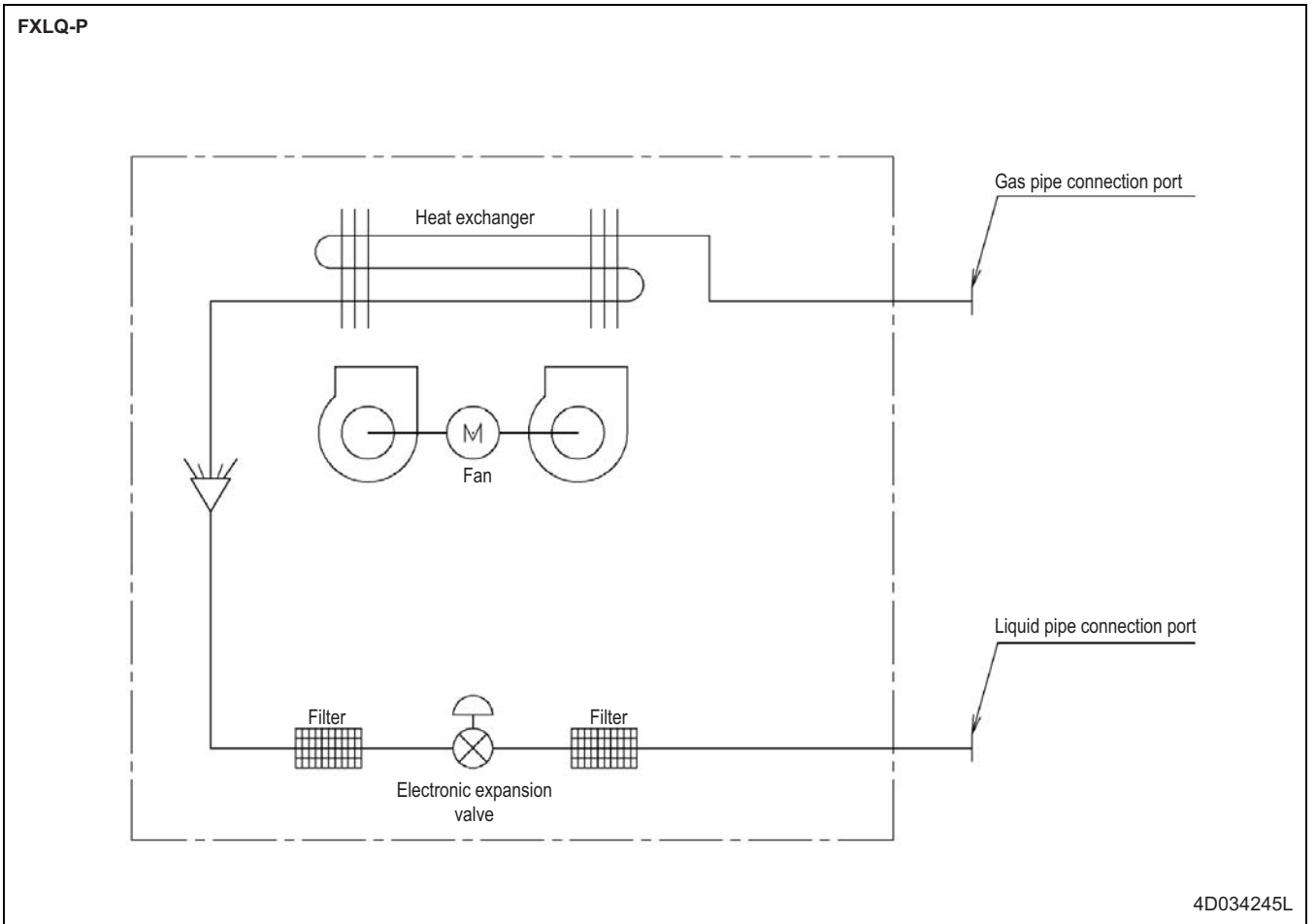

9 Wiring diagrams

9 - 1 Wiring Diagrams - Single Phase

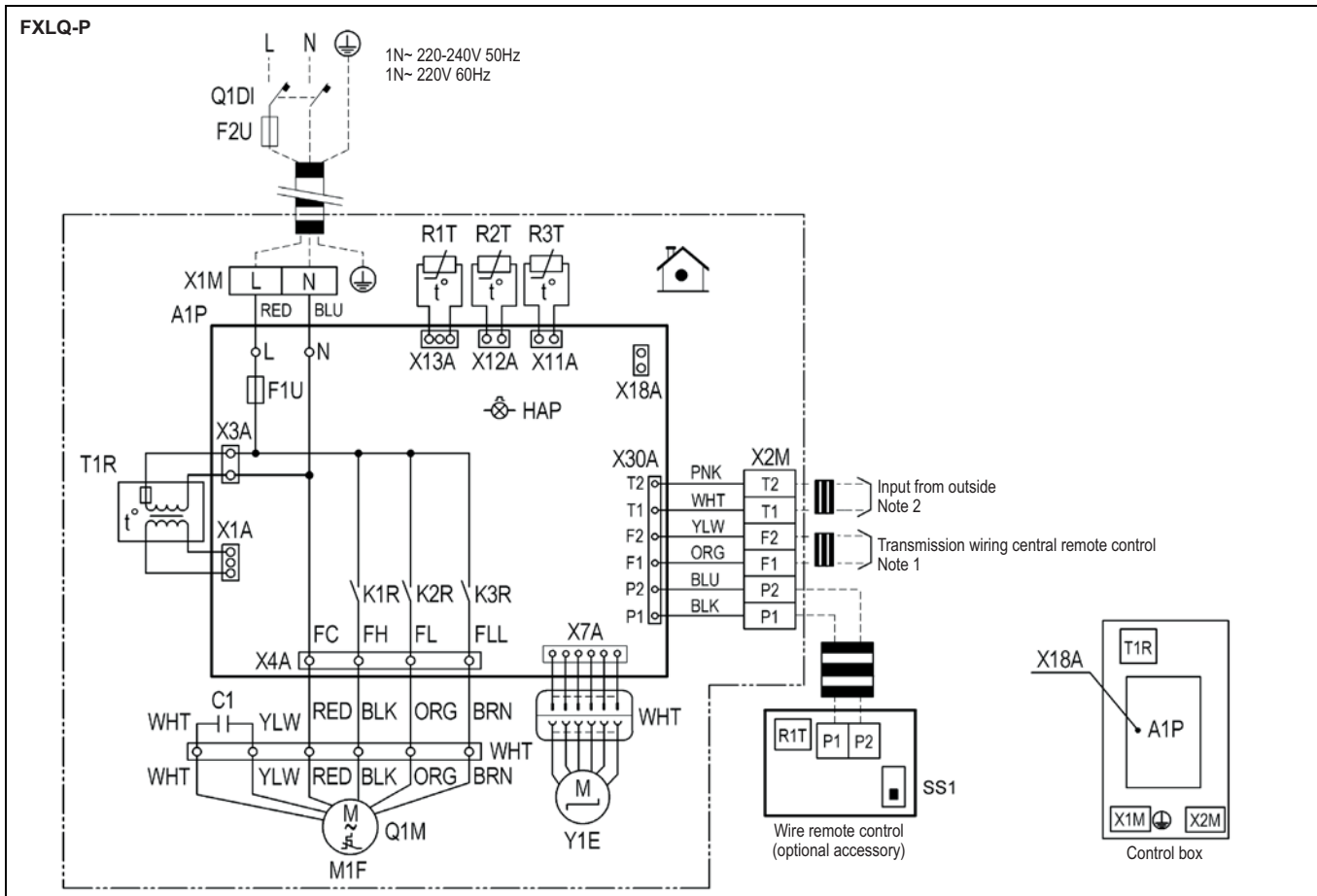

Indoor unit	
A1P	Printed circuit board
C1	Capacitor (M1F)
F1U	Fuse (B , 5A, 250V)
F2U	Field Fuse
HAP	Light emitting diode (service monitor green)
K1R-K3R	Magnetic relay (M1F)
M1F	Motor (indoor fan)
Q1M	Thermo switch (M1F embedded)
Q1DI	Earth Leak Detector
R1T	Thermistor (air)
R2T-R3T	Thermistor (coil)
T1R	Transformer (220-240V/22V)
X1M	Terminal block (power supply)
X2M	Terminal block (control)
Y1E	Electronic expansion valve
Wired remote control	
R1T	Thermistor (air)
SS1	Select switch (main/sub)
Connector optional accessory	
X18A	Connector (wiring adapter for electrical appendices)

Colors	
BLK	: Black
BLU	: Blue
BRN	: Brown
ORG	: Orange
PNK	: Pink
RED	: Red
WHT	: White
YLW	: Yellow

2D077874

NOTES

- When using the central remote control see manual for connection to the unit.
- When connecting the input wires from outside, forced "OFF" or "ON/OFF" operation can be selected by the remote control. See installation manual for more details.
- Use copper conductors only.

	: Terminal block		: Connector
	: Field wiring		: Terminal
L	: Live		: Protective earth (screw)
N	: Neutral		
	: Connector		

10 Sound data

10 - 1 Sound Pressure Spectrum

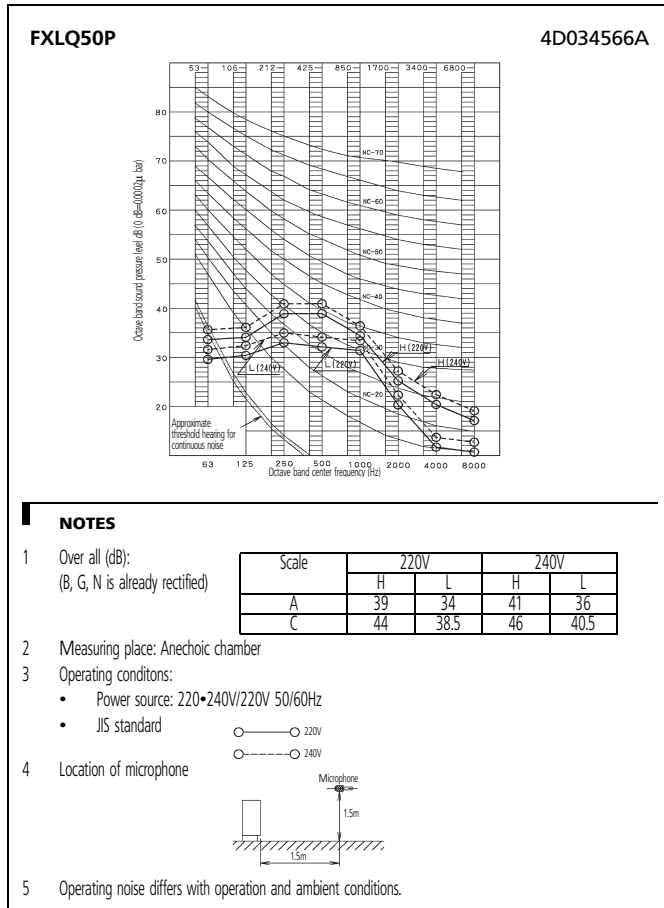
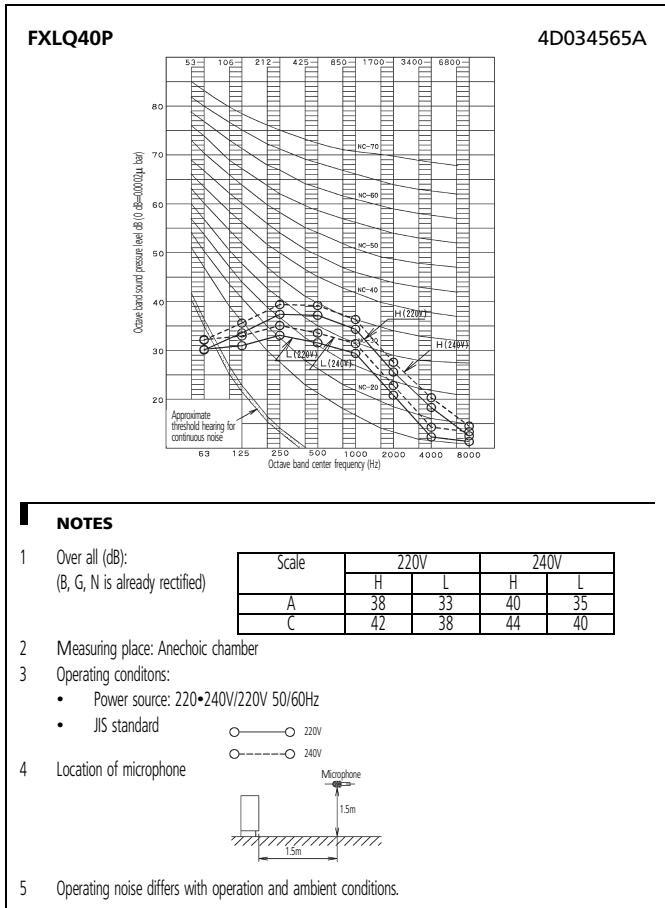
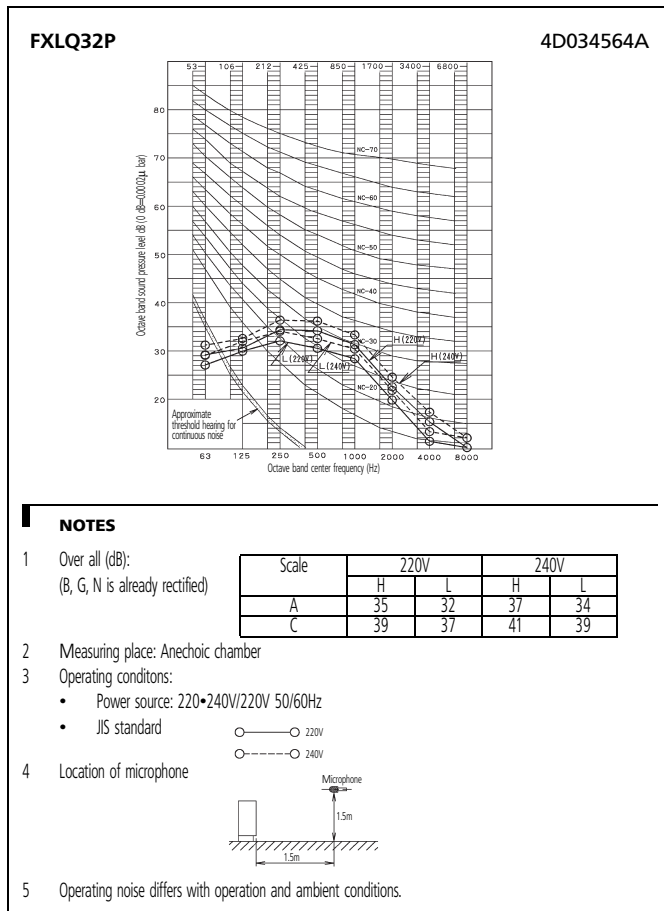
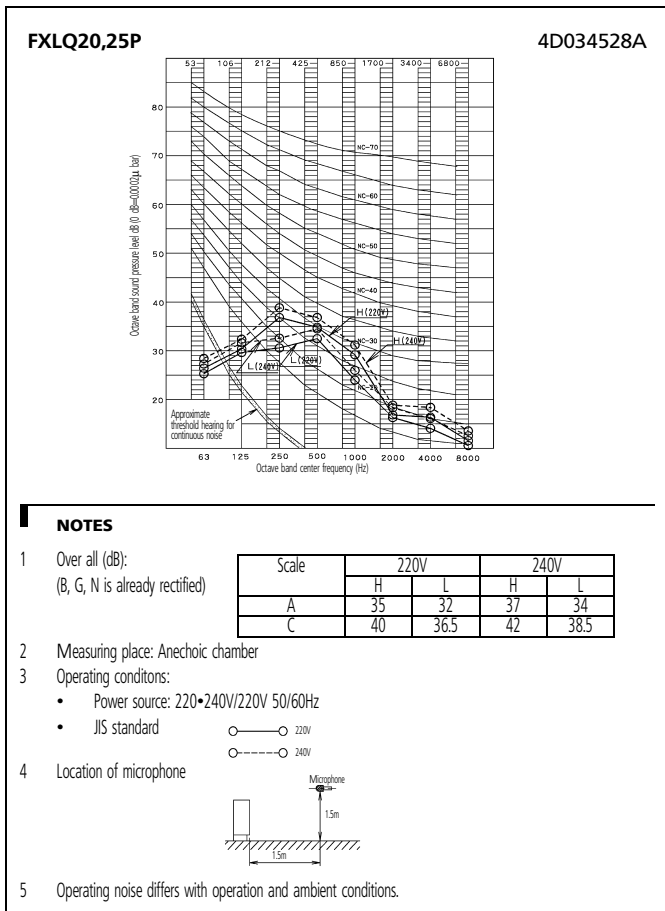

10 Sound data

10 - 1 Sound Pressure Spectrum

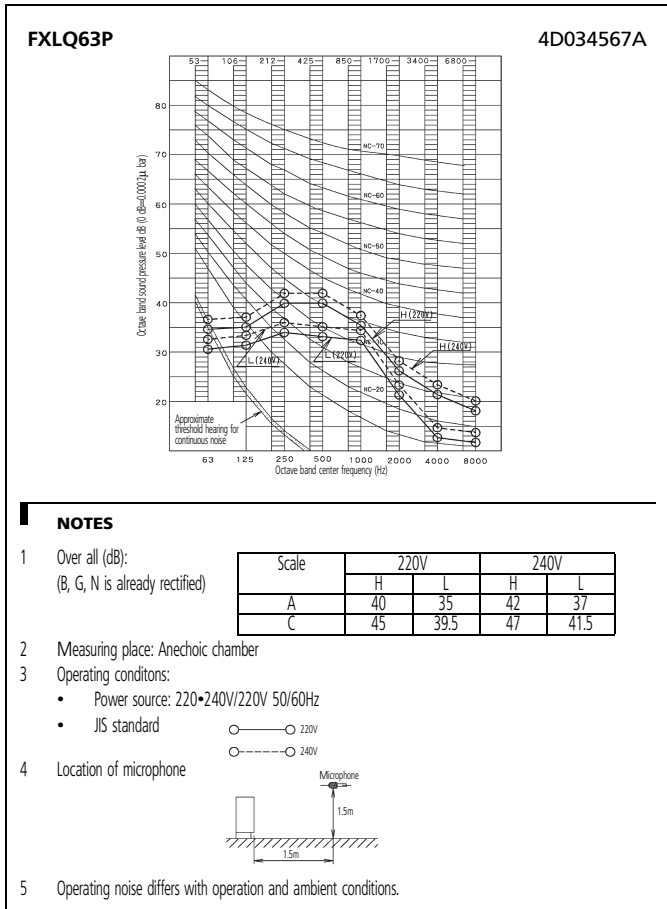



These products are not within the scope of the Eurovent certification program

The present leaflet is drawn up by way of information only and does not constitute an offer binding upon Daikin Europe N.V.. Daikin Europe N.V. has compiled the content of this leaflet to the best of its knowledge. No express or implied warranty is given for the completeness, accuracy, reliability or fitness for particular purpose of its content and the products and services presented therein. Specifications are subject to change without prior notice. Daikin Europe N.V. explicitly rejects any liability for any direct or indirect damage, in the broadest sense, arising from or related to the use and/or interpretation of this leaflet. All content is copyrighted by Daikin Europe N.V.

BARCODE

Daikin products are distributed by: